



Balls

Definition:

A "Ball" is the spherically shaped member with a neck and seat. The seat rests upon a hitch platform. A threaded portion of the ball shank extends through the hitch platform and is fastened to it with a lock washer and nut so that the ball will remain tight on the hitch.

Classification:

Balls are classified by relating the diameter of the ball to a specific Trailer Classification.

Trailer Classification	Ball Diameter
Class 1	1-7/8"
Class 2	2"
Class 3	2"
Class 4	2-5/16"

Types:

There are many types of balls on the market. Some are made in one piece, others are made in two or more pieces (a bolt extends down through the center of the ball portion). They are also made in various heights and shapes.

Identification:

Most balls are identified on the top with the ball diameter such as 1-7/8", 2", etc. The ball should be used with the Trailer Classification as described above. It is recommended that a ball conforming to the strength and dimensional requirements of SAE J684 be use with a BULLDOG coupler.

1 7/8" Ball Diameter (A)

Part # Zinc Finish	Part # Chrome Finish	Part # Stainless Steel	Shank Diameter (B)	Shank Length (C)	Capacity	Notes
-	2032	-	3/4" Internal	1 3/4"	2,000 lbs	Internal Thread

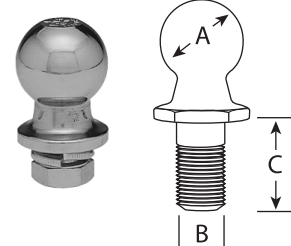

Part # Zinc Finish	Part # Chrome Finish	Part # Stainless Steel	Shank Diameter (B)	Shank Length (C)	Capacity	Notes
5011	-	-	3/4"	1 1/2"	2,000 lbs	Bulk
-	5013	-	3/4"	1 1/2"	2,000 lbs	Retail Package
5021	5022	-	3/4"	2 3/8"	2,000 lbs	Bulk
-	4102	-	3/4"	3 3/8"	2,000 lbs	X-Long Shank
-	5033	-	1"	2 3/8"	2,000 lbs	Retail Package
4121DT	-	-	1"	3 1/8"	2,000 lbs	X-Long Shank
-	-	2291	1"	2 1/8"	5,000 lbs	Retail Package



Part # Zinc Finish	Part # Chrome Finish	Part # Stainless Steel	Shank Diameter (B)	Shank Length (C)	Capacity	Notes
-	2301	-	1"	2 1/4"	2,000 lbs	Pintle Hook Replacement
-	2307	-	1 1/8"	2 1/4"	2,000 lbs	Pintle Hook Replacement



Information

Hubs
and Axles

Brake
Assemblies

Suspensions
& Fasteners

Tires &
Wheels

Couplers,
Jacks &
Winches

Hitches &
Towing
Accessories

Body
Components

Boat
Trailer Parts

Lights &
Electrical

Locks &
Cargo Control

Brake
Actuating
Systems

Switches

2" Ball Diameter (A)

2082



Part # Zinc Finish	Part # Chrome Finish	Part # Stainless Steel	Shank Diameter (B)	Shank Length (C)	Capacity	Notes
-	2082	-	3/4" Internal	1 3/4"	3,500 lbs	Internal Thread

80020



Part # Zinc Finish	Part # Chrome Finish	Part # Stainless Steel	Shank Diameter (B)	Shank Length (C)	Capacity	Notes
-	5063	-	3/4"	1 1/2"	3,500 lbs	Retail Package
-	-	2292	3/4"	2 1/4"	5,000 lbs	Retail Package
5071*	5072	-	3/4"	2 3/8"	3,500 lbs	Retail Package
-	4112DT	-	3/4"	3 3/8"	3,500 lbs	X-Long Shank
-	5083	-	1"	2 1/8"	6,000 lbs	Retail Package
-	-	2293	1"	2 1/4"	7,000 lbs	Retail Package
-	2203	-	1"	2 1/8"	8,000 lbs	Heavy Duty
-	4132	-	1"	3 3/8"	6,000 lbs	X-Long Shank
-	2192	-	1 1/4"	2 1/8"	8,000 lbs	Bulk

*Bulk - Not packaged

Couplers,
Jacks &
Winches



Part # Zinc Finish	Part # Chrome Finish	Part # Stainless Steel	Shank Diameter (B)	Shank Length (C)	Capacity	Notes
-	80020	-	1"	2"	5,000 lbs	2" Rise Ball

Hitches &
Towing
Accessories

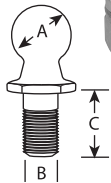

2312

Part # Zinc Finish	Part # Chrome Finish	Part # Painted Finish	Shank Diameter (B)	Shank Length (C)	Capacity	Notes
-	2302	-	1"	2 1/4"	10,000 lbs	Pintle Hook Replacement
-	2308	-	1 1/8"	2 1/4"	7,000 lbs	Pintle Hook Replacement
-	-	2312	1 1/4"	3"	7,500 lbs	Pintle Hook Replacement

2 5/16" Ball Diameter (A)



Part # Painted Finish	Part # Chrome Finish	Part # Stainless Steel	Shank Diameter (B)	Shank Length (C)	Capacity	Notes
-	-	2294	1"	2"	10,000 lbs	Retail Package
-	5044	-	1"	2 1/8"	8,000 lbs	Retail Package
-	5042	-	1"	2 1/8"	8,000 lbs	Bulk
-	5092	-	1 1/4"	2 1/4"	10,000 lbs	Retail Package
2195	-	-	1 1/4"	2 1/4"	25,000 lbs	Bulk

Body
Components

Boat
Trailer Parts

Lights &
Electrical

Locks &
Cargo Control

Brake
Actuating
Systems

Switches

2311



Part # Zinc Finish	Part # Chrome Finish	Part # Plain or Painted	Shank Diameter (B)	Shank Length (C)	Capacity	Notes
-	2303	-	1"	2 1/4"	10,000 lbs	Pintle Hook Replacement
-	2309	-	1 1/8"	2 1/8"	10,000 lbs	Pintle Hook Replacement
-	2310	-	1 1/4"	2 1/4"	12,000 lbs	Pintle Hook Replacement
-	-	2311	1 1/4"	3"	9,000 lbs	Pintle Hook Replacement

2190



Part # Zinc Finish	Part # Chrome Finish	Part # Plain or Painted	Shank Diameter (B)	Shank Length (C)	Capacity	Notes
-	-	2190	1 1/4"	2 1/4"	25,000 lbs	1" Rise



2 5/16" Ball Diameter (A) - Continued

Part # Zinc Finish	Part # Chrome Finish	Part # Plain or Painted	Shank Diameter (B)	Shank Length (C)	Capacity	Notes
-	-	7047	1 1/4"	3 1/2"	30,000 lbs	1" Rise, Extra Long Shank
-	-	7048	1 3/8"	3 1/2"	30,000 lbs	1" Rise, Extra Long Shank

Part # Zinc Finish	Part # Chrome Finish	Part # Plain or Painted	Shank Diameter (B)	Shank Length (C)	Capacity	Notes
-	80025	-	1 1/4"	2"	7,500 lbs	2" Rise
-	-	2196	1 1/4"	2 1/8"	30,000 lbs	2" Rise
-	-	2198	1 1/2"	2 3/4"	30,000 lbs	2" Rise

Part # Zinc Finish	Part # Chrome Finish	Part # Plain or Painted	Shank Diameter (B)	Shank Length (C)	Capacity	Notes
-	-	2193	1 3/8"	2 1/4"	40,000 lbs	Bulk

Part # Zinc Finish	Part # Chrome Finish	Part # Plain or Painted	Shank Diameter (B)	Shank Length (C)	Capacity	Notes
-	-	5973	2 3/16"	2 3/4"	30,000 lbs	Smooth Shank
-	-	2184	2 3/16"	4"	30,000 lbs	Smooth Shank

* Uses #2185 collar - Shown Below

3" Ball Diameter (A)

Part # Zinc Finish	Part # Plain or Painted	Shank Diameter (B)	Shank Length (C)	Capacity	Notes
-	2300	2"	3 1/4"	20,000 lbs	Bulk
6303	-	2 3/16"	2 3/4"	30,000 lbs	Smooth Shank

Trailer Ball Cover

Part #	Description
2576	Fits 1 7/8" and 2" Trailer Balls
2577	Fits 2 5/16" Trailer Balls

Reducer Bushings/Collar

Part #	Description
2561	Adapts 3/4" Shank Ball to fit 1" Hole
2562	Adapts 1" Shank Ball to fit 1 1/4" Hole
2185	Collar for #2184 Smooth Shank Ball, 3" long, 2 3/16" ID, 2 3/4" OD

Trailer Hitch Grease

Part #	Description
211748	For use on trailer hitch ball and coupling. Contains rust and oxidation inhibitors and PTFE for added friction reduction. Water washout resistant. Tubes can stand alone or be pegged.



80025



2184



6303



2562



2561

2185



Information

Hubs
and Axles

Brake
Assemblies

Suspensions
& Fasteners

Tires &
Wheels

Couplers,
Jacks &
Winches

Hitches &
Towing
Accessories

Body
Components

Boat
Trailer Parts

Lights &
Electrical

Locks &
Cargo Control

Brake
Actuating
Systems

Switches