

Installation Instructions

1801105 2-1/2" Receiver Hitch 1801106 2" Receiver Hitch

Applications

2001-present Chevy/GMC 2500HD & 3500 Pickup Trucks, 2 & 4 wheel drive

Capacity

16,000 lbs. Maximum Gross Trailer Weight (MGTW)
 1,600 lbs. Maximum Vertical Load (MVL)

Tools Required

- 9/16" Drill Bit
- 13/16" Wrench
- 7/8" Wrench and/or Socket
- 21mm Wrench
- 22mm Wrench and/or Socket
- Torque Wrench

Trucks with factory installed bumper.

1. Remove the two M14 bolts at the rear of the frame and discard.
2. Position the hitch against the frame and align the hitch's rear slots with the frame's M14 weldnuts.
3. Fasten hitch to frame with two M14 x 40mm screws, lock washers and reinforcement blocks in the hitch's rear slots as shown in figure 1. Do not tighten completely at this time.
4. Install two 9/16 x 2" screws, reinforcement blocks, flat washers and lock nuts in the forward most holes as shown in figure 1. Do not tighten completely at this time.
5. For short bed trucks, the center hole must be drilled at this time. For long bed trucks, skip to step 6. Using the center hitch holes as a template drill two 9/16" holes in the frame. Be careful not to drill into any lines or wire harnesses on the back side of the frame.
6. Install two 9/16 x 2" screws, reinforcement blocks, flat washers and lock nuts in the center holes as shown in figure 1.
7. Using a torque wrench, torque the M14 CL10.9 bolts to 135 ft-lbs and torque the 9/16" G8 bolts to 120 ft-lbs.

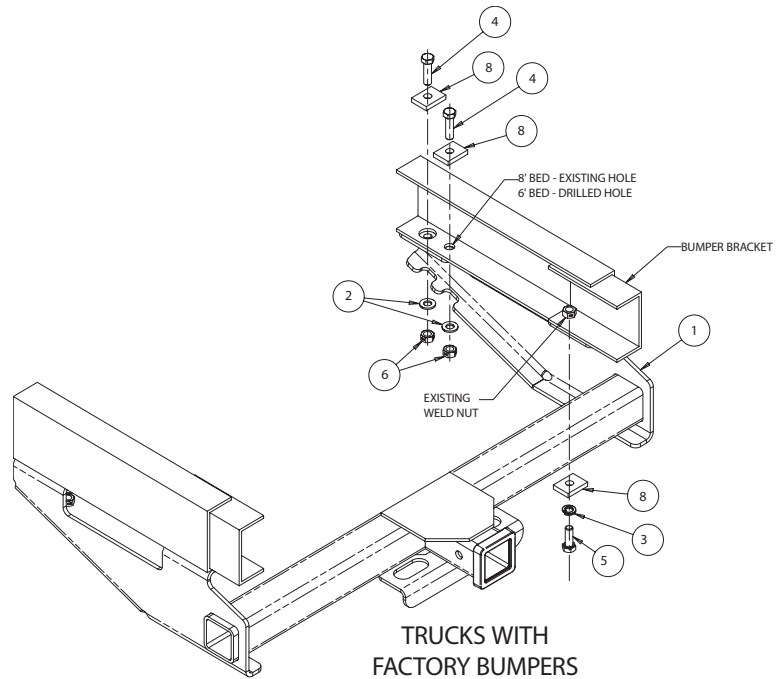

TRUCKS WITH
 FACTORY BUMPERS
 FIGURE 1

Bill of Materials

ITEM	PART NO.	QTY.	DESCRIPTION
1	-	1	Hitch, Receiver GM, 2500 & 3500
2	-	6	Washer, Flat 9/16 SAE, Hardend Steel, ZY
3	-	2	Washer, Split Lock 9/16 ZN
4	-	4	Screw, Hex HD Cap 9/16-18 x 2 GR8 ZN
5	-	2	Screw, HHC, M14 x 2 x 40, CL10.9, Black Oxide
6	-	4	Nut, Hex 9/16-18 Center Lock ZN
7	-	2	Nut, M14 x 2, ZN
8	-	6	Spacer Block

Trucks without factory installed bumper.

Note: It may be necessary to relocate the license plate mounting bracket in order to complete the hitch installation.

1. Position the hitch against the frame and align the hitch's rear slots with the fore/aft slots in the rear of the frame.
2. Fasten hitch to frame with two M14 x 40mm screws, flat washers, lock washers, reinforcement blocks and nuts in the hitch's rear slots as shown in figure 2. Do not tighten completely at this time.
3. Install two 9/16 x 2" screws, reinforcement blocks, flat washers and lock nuts in the forward most holes as shown in figure 1. Do not tighten completely at this time.
4. For short bed trucks, the center hole must be drilled at this time. For long bed trucks, skip to step 6. Using the center hitch holes as a template drill two 9/16" holes in the frame. Be careful not to drill into any lines or wire harnesses on the back side of the frame.
5. Install two 9/16 x 2" screws, reinforcement blocks, flat washers and lock nuts in the center holes as shown in figure 1.
6. Using a torque wrench, torque the M14 CL10.9 bolts to 135 ft-lbs and torque the 9/16" G8 bolts to 120 ft-lbs.

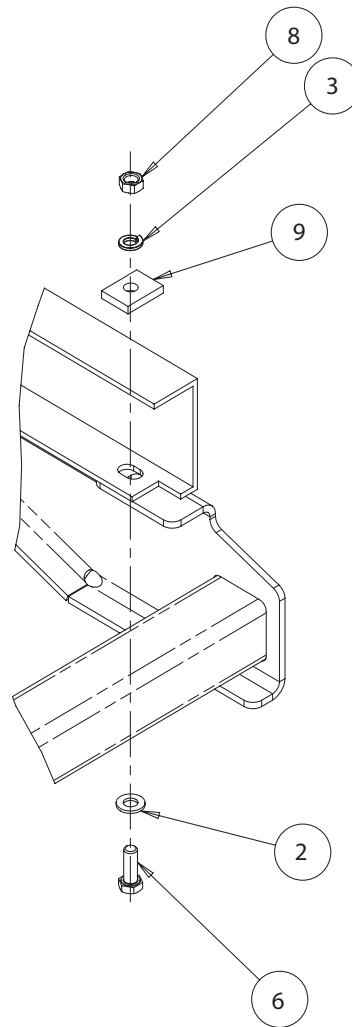

**Trucks Without
 Factory Bumpers
 Figure 2**

WARRANTY

Buyers Products Co. warrants all truck/trailer hardware manufactured or distributed by it, to be free from defects in material and workmanship for a period of one year from date of shipment. Parts must be properly installed and used under normal conditions. Any product which has been altered, including modification, misuse, accident or lack of maintenance will not be considered under warranty. Normal wear is excluded. The sole responsibility of Buyers Products Co. under this warranty is limited to repairing or replacing any part or parts which are returned, prepaid, and are found to be defective by Buyers Products Co. Authorization from Buyers Products Co. must be obtained before returning any part. No charges for transportation or labor performed on Buyers' products will be allowed under this warranty.